



CELEBRATING
55 YEARS

nerej

DApice of The Mega Group brokers \$185,000 land sale of 79.4 acres

May 06, 2022 - Front Section

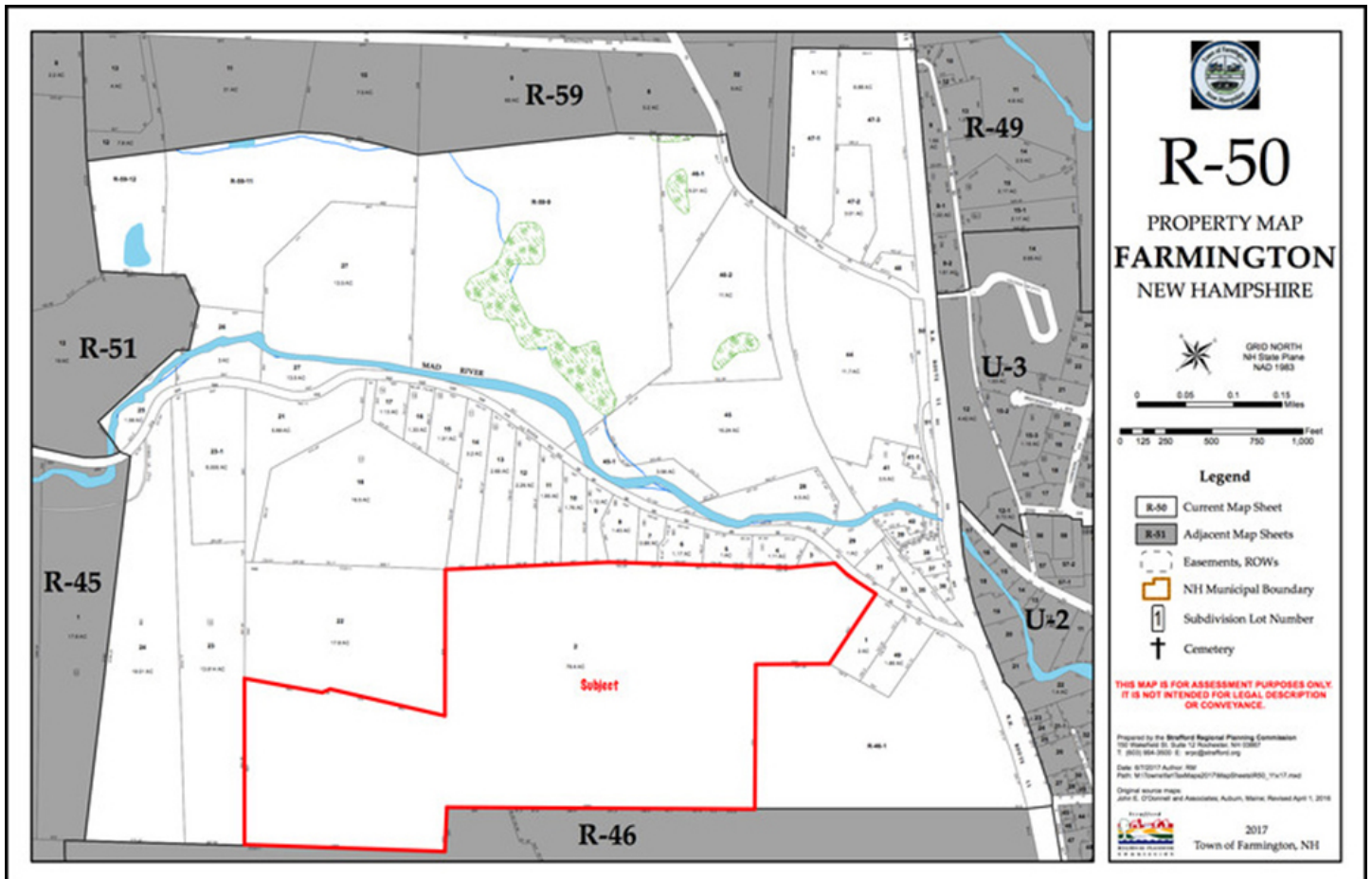

Farmington, NH The Mega Group has facilitated the sale of 79.4 acres of residentially zoned developable land located along the Mad River. The subject property is at the junction of the Henry Wilson Hwy. (Rte. 11) and less than a mile from the Mad River Conservation Land, The Flume. The sale of the real estate occurred on April 27, for \$185,000.

Brian DApice of the Mega Group represented the buyers in the transaction and the sellers, Woodward Realty Company, were unrepresented in the off-market transaction.

Farmington is a rural town in Strafford County and home to Blue Job State Forest, the Tebbetts Hill Reservation, and Baxter Lake. Known as the “Gateway to the Lakes Region” of New Hampshire, the town is a mix of industrial, retail, and service sector business, with a downtown that still reflects its past in a quaint and attractive Olde New England setting.

